

Connecting to the iNet-X App

Locate and press the iNet-X app icon and press.

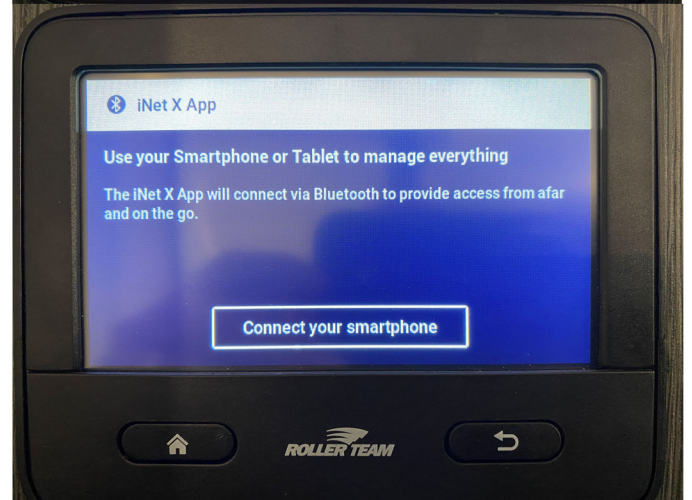

Press “Connect your smartphone”



If you haven't downloaded the app on your phone, press the “Download App” otherwise press “Continue”



Download the app by scanning the QR Code or searching the Apple App Store, or Goggle Play

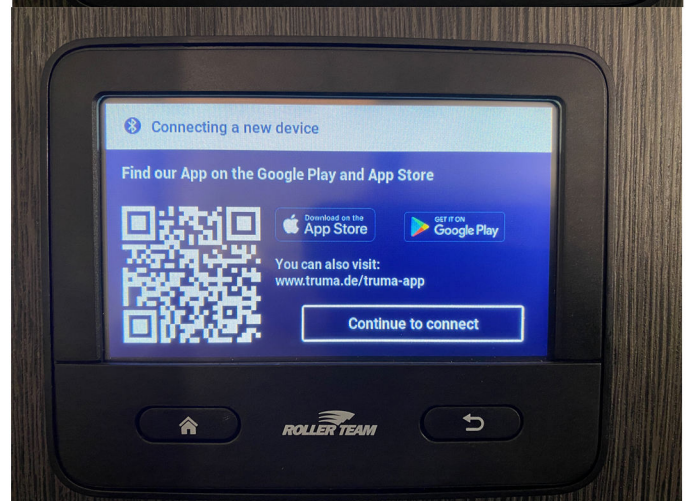

If you haven't already, you will need to create an **b2clogin.com** account to sign into the iNet-X app. Select continue, fill in your details and follow the prompts.

When you press the connect a new device you get the panel ID number and a PIN to connect your phone via Bluetooth.

Select the ID number on the phone app and enter the PIN and press "Pair"

You can now use the phone app to control your Truma iNet X panel.

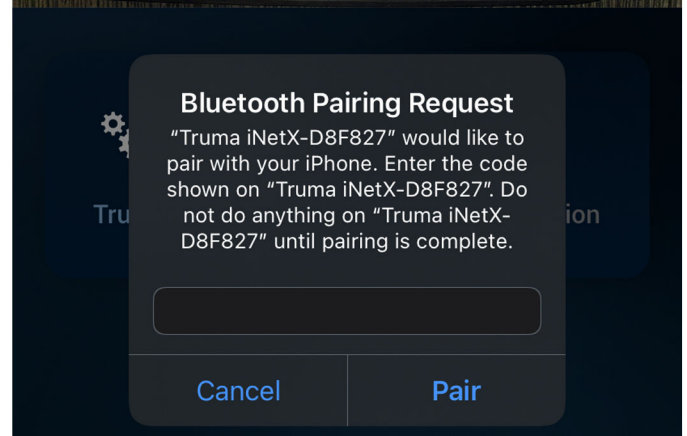
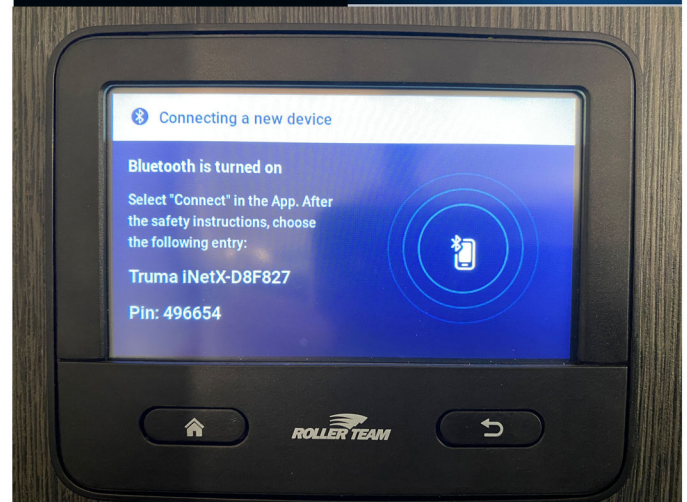
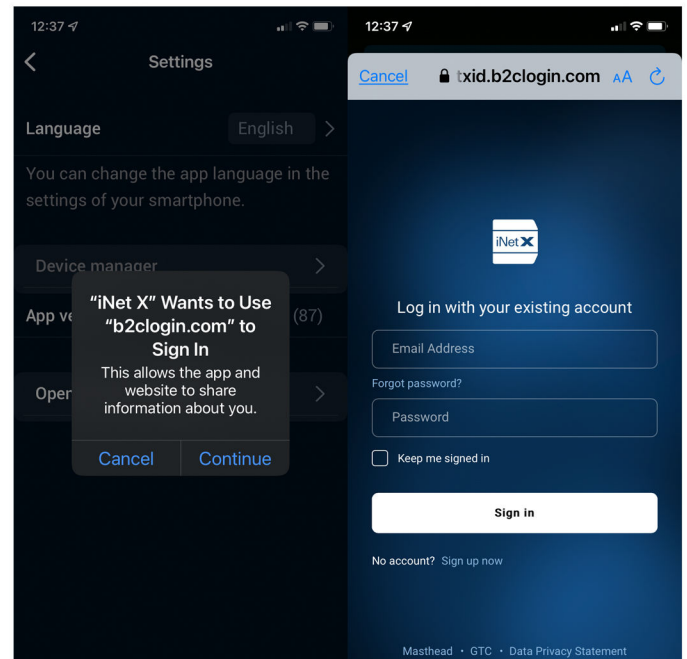

From the app you can check your resources, control your room climate and hot water boiler. As well as switches for the lights and water pump. - **If on initial use a pop up appears saying an upgrade to the firmware is required, see the following firmware update page.**

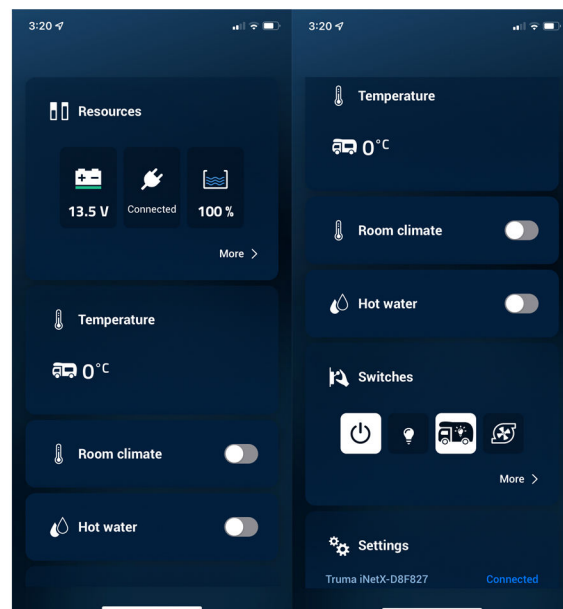

When operating the panel, you have 8 buttons on the home screen.

Resources - Switches - Room Climate Notifications - Warm Water - Turn Off, iNet-X App - Settings



Resources shows you readings for the vehicle and habitation batteries, as well as the level for the fresh water and waste water.



Switches shows the switches for the water pump, the outdoor light, and the indoor lighting. Each icon can be touched to turn the item on or off.

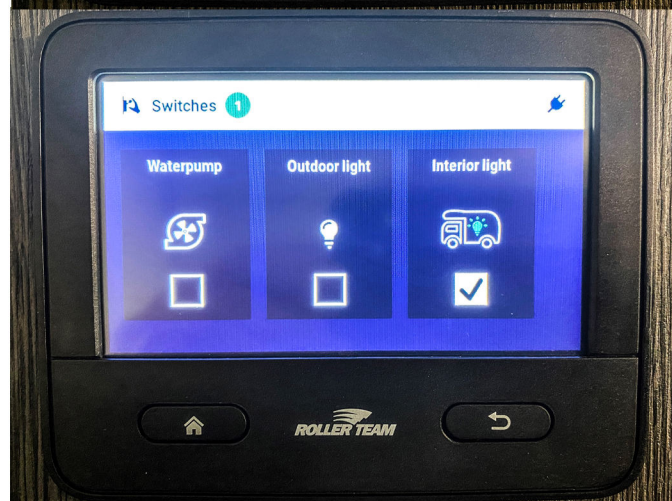

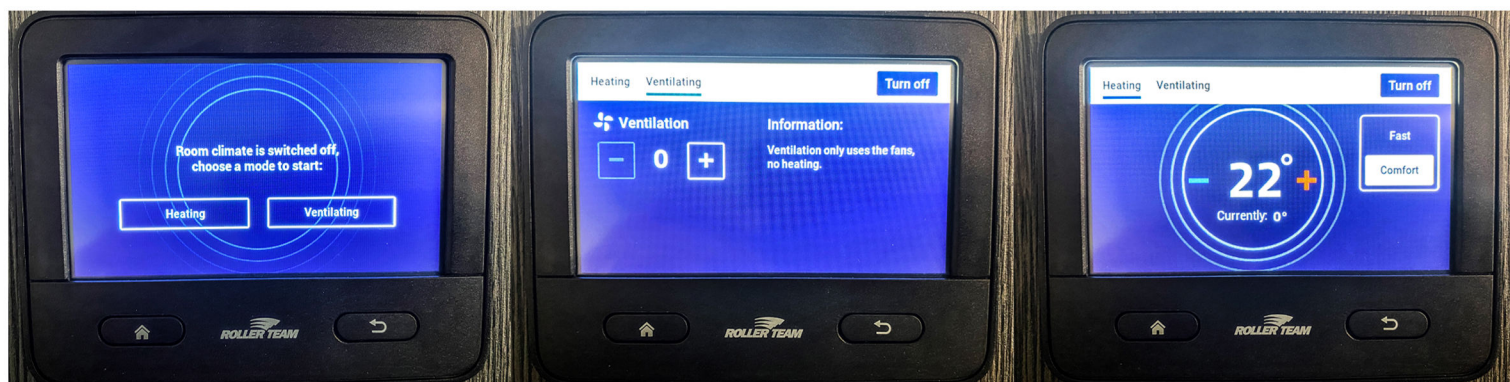

Room climate gives you the option of choosing between fresh air ventilation by adjusting the fan speed, or adding heat by adjusting the desired temperature.



Warm water gives you the option of choosing between 40° (suitable for dishes) and 60° (suitable for showering)

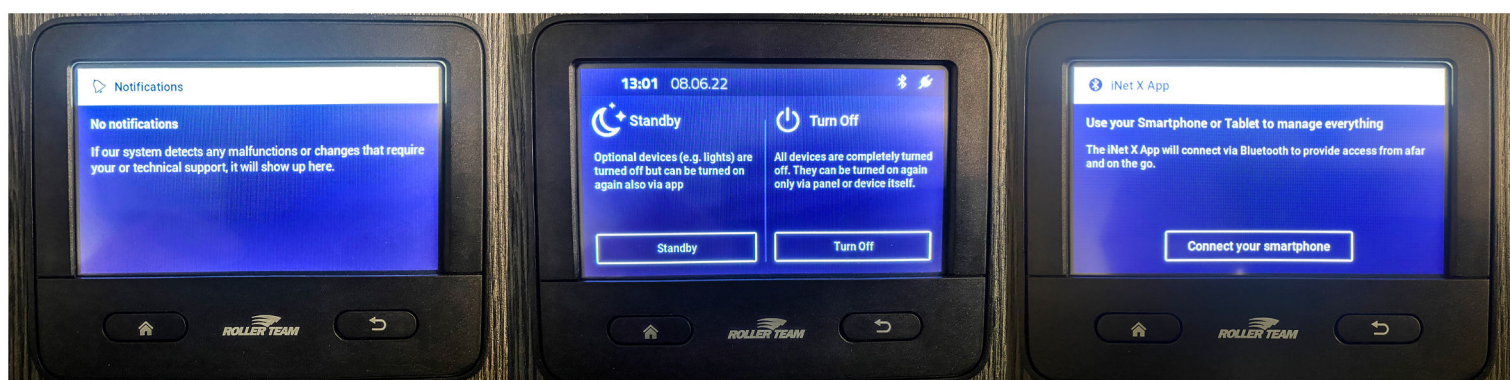

The notification screen will show any notifications and error messages

The turn off button gives you the option of switching to standby, or turning the panel completely off.

The iNet-X App button starts the process of connecting your smart phone using the iNet-X app.

Settings Menu

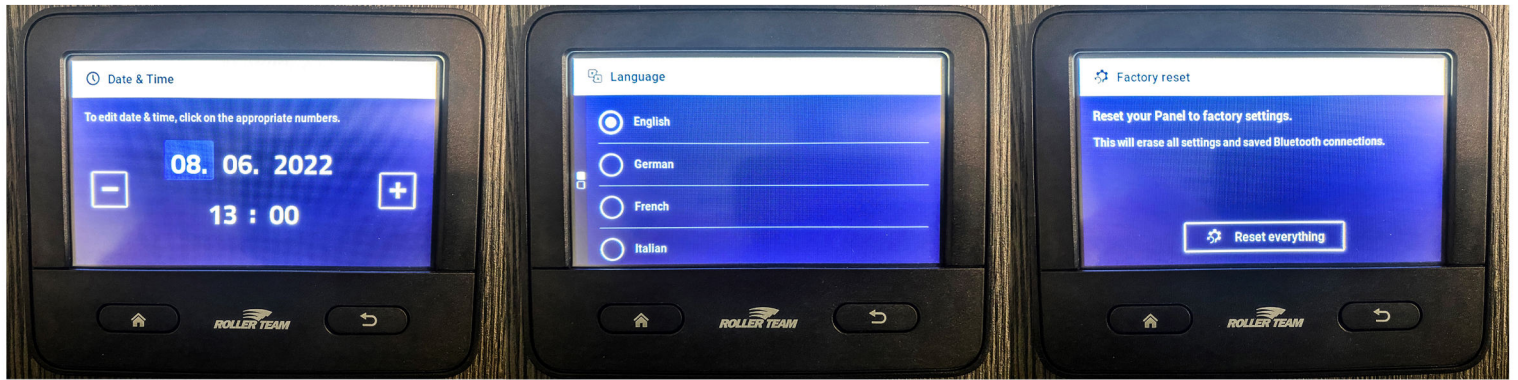

You can adjust this screen to the correct date and time.

Select and set to your desired language.

Reset the panel completely. (you will reset your settings including any bluetooth connections).

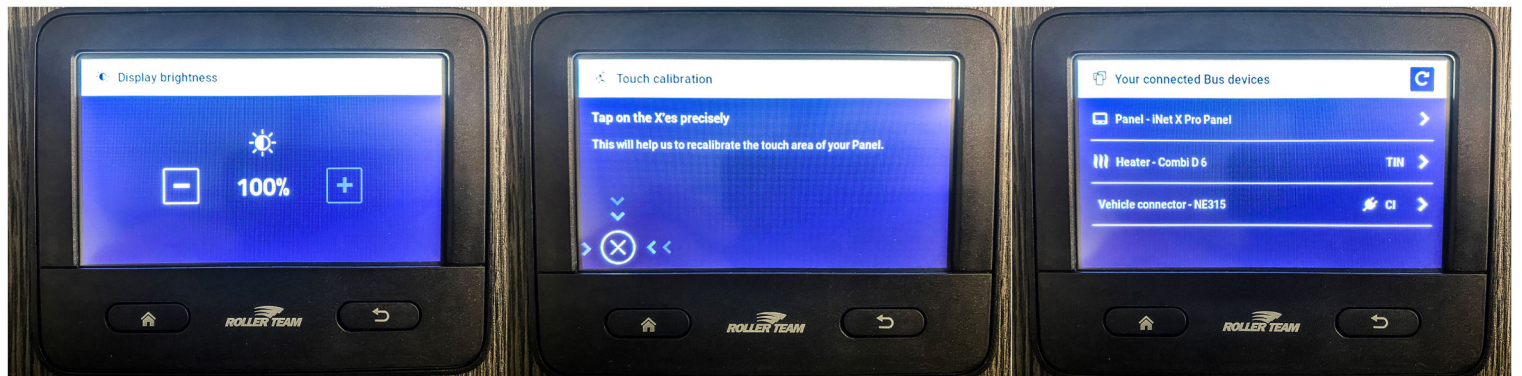

Adjust your screen brightness

Re-calibrate your touch screen by touching the x's in the 4 corners.

Contains information regarding devices connected to your panel. (nothing in here you should be changing).

Firmware Update

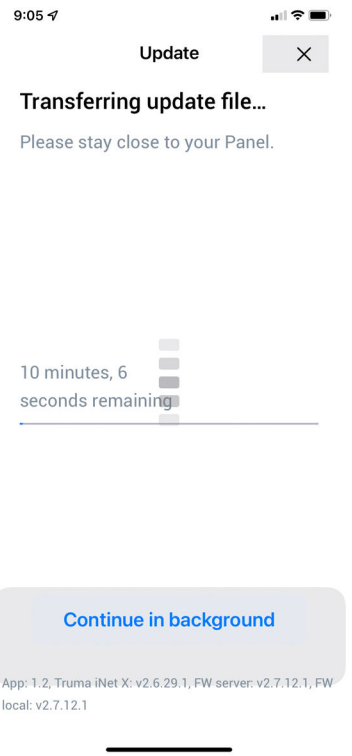
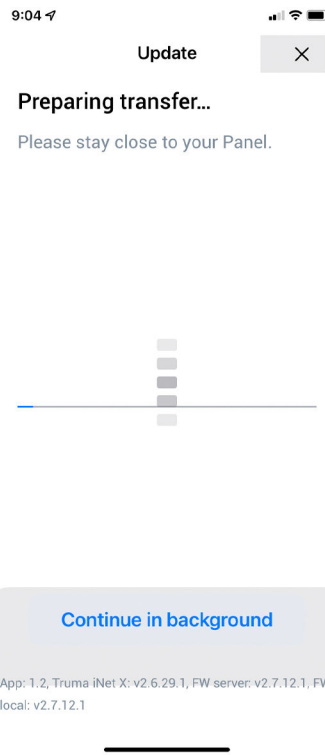
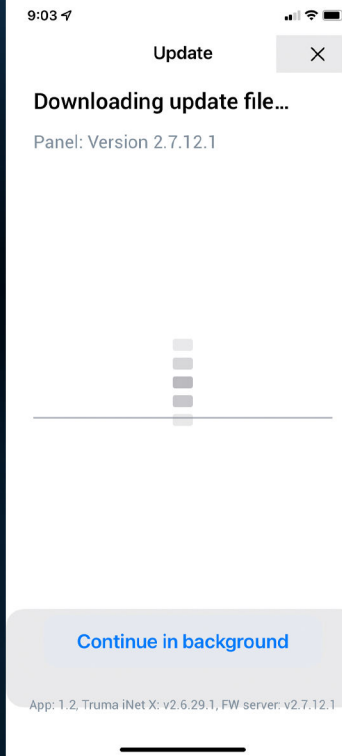
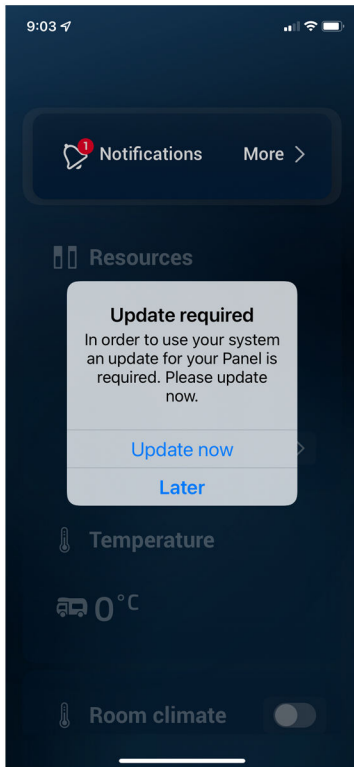

If you get a notification to update your firmware, follow the process through downloading, preparing and transferring the file using the iNet-X app on your smartphone, then installing the firmware update using your panel.

